



## BALUSTRADE SYSTEMS

Classically designed Architectural Urethane<sup>TM</sup> balustrades are available in a wide variety of sizes and designs to enhance the beauty of any project. Ideal for elevated applications such as balconies and widow's walks where excess weight is a concern, Architectural Urethane<sup>TM</sup> balustrades are just as at home on the patio, pool deck or porch. Constructed from high density urethane and structural piping, durable Architectural Urethane<sup>TM</sup> balustrades are BOCA compliant, and designed to meet local baluster spacing and rail height codes. In addition to our large inventory of standard designs, custom balusters can be produced upon request. Radius railings are also available.

In addition to our Architectural Urethane<sup>TM</sup> balustrade system, we also offer balustrades in MeltonStone<sup>TM</sup> cast stone, MarbleTex<sup>TM</sup> synthetic stone, & DuraClassic<sup>TM</sup> marble/resin composite, See Sweet's 05720 for more inf.

### Extended balusters for Stair Applications

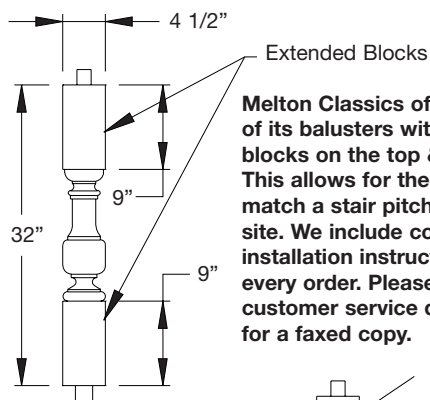

*If you're looking for a baluster that's not in our catalog. Fax us a detailed drawing and we'd be happy to quote on it. Fax (770) 962-6988.*

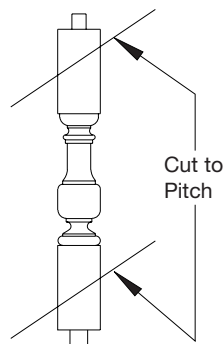

**NOTE:** When cutting baluster to pitch, do **NOT** cut through pipe. Allow pipe to extend a min. of 1 1/2" beyond pitch.

### Balustrade Systems and Building Codes

NOTE: Melton Classics recommends checking with your local building inspector before ordering your railing system.

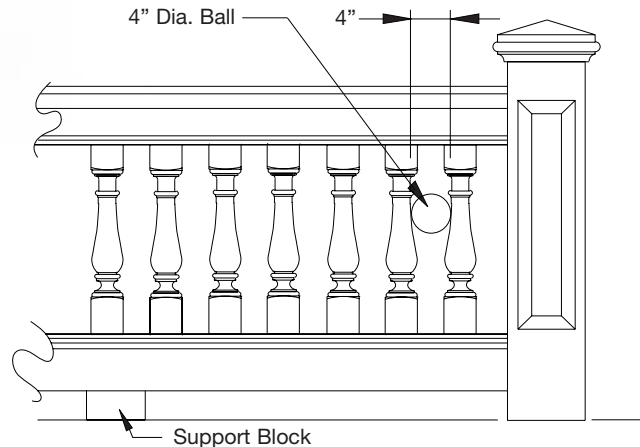

### Railing Codes

It is important to check with your local building inspector regarding the code for baluster spacing and railing height. Most states are using a 4" code for balusters, which means that a 4" ball cannot pass between the balusters. We provide you with an on center spacing for each baluster based on this code. Some balusters do not meet code and can only be used in areas that are not considered accessible to the public. Example: A portico or front balcony that does not have an operating window or door leading to it that could be used in case of fire. ***It is imperative that you check with your building inspector before ordering your railing system.***

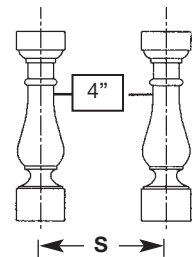

**S = Spacing on center**

### IMPORTANT - Please Read

Melton Classics will in no way be held responsible or liable for any railing installation regardless of the code requirements. All railing installations are the sole responsibility of the balustrade installer.



## BALUSTRADE SYSTEMS

### 12" Railing System

#### Balusters



S = 7 3/8"

250-400-36 Baluster

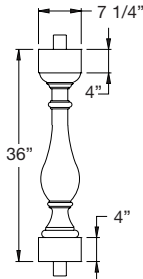

S = 8"

250-410-28 Baluster

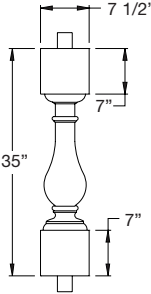
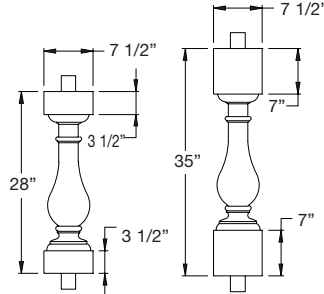

250-410-35 Baluster



S = 7 5/8"

250-420-20 Baluster



S = 7"

250-440-30 Baluster

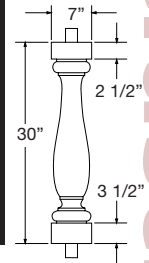

#### Top & Bottom Rails

AVAILABLE IN 8' & 10' LENGTHS

251-400-8 Top Rail  
251-400-10 Top Rail

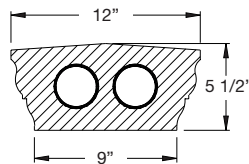

251-405-8 Bottom Rail  
251-405-10 Bottom Rail

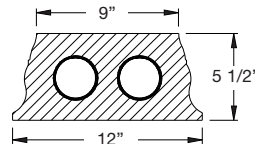
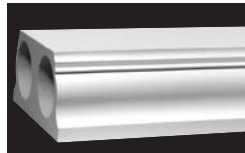

#### IMPORTANT

- ▶ Rails are joined to newel posts and not to each other. Other applications will not be covered under the warranty.
- ▶ On spans of more than 8 feet, we recommend installing support blocks.
- ▶ Installation kits are available to join rails to newel posts. (see page 17)
- ▶ 251-400 & 251-405 Rails are made with PVC pipe that meets BOCA Codes.
- ▶ Railings can be pre-drilled. See page 16.

#### Curved Railings

- ▶ Curved railings available by quotation. See page 16 for stock sizes and instructions.

#### Newel Posts



252-400 Newel Post  
Ht.: 48" W.: 12 3/4"sq.

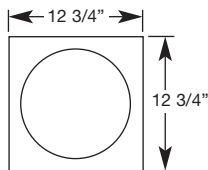

252-410 Newel Post 252-420 Newel Post  
Ht.: 48" W.: 12 3/4"sq. Ht.: 48" W.: 12 3/4"sq.

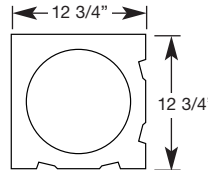
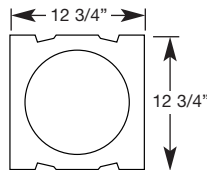

#### NOTE:

Newel Posts can be cut to specific heights. Please specify.  
Installation hardware available for Newel Posts. (see page 17)

#### Newel Caps



253-400 Newel Cap  
13 3/4" Square



253-420 Newel Cap  
13 3/4" Square



253-410 Newel Cap  
13 3/4" Square

#### NOTE:

Newel Caps are ordered as a separate piece.

balustrade systems